

State of California - The Resources Agency
DEPARTMENT OF PARKS AND RECREATION

HISTORIC RESOURCES INVENTORY

(State use only)

Ser _____ Site _____ Mo. _____ Yr. _____
 UTM _____ Q _____ NR _____ SHL _____
 Lat _____ Lon _____ Era _____ Sig _____
 Adm _____ T2 _____ T3 _____ Cat _____ HABS _____ HAER _____ Fed _____

11/433620/3773700

IDENTIFICATION

- Common name: _____
- Historic name, if known: _____
- Street or rural address 425 West 10th St.
 City: Claremont ZIP: 91711 County: Los Angeles
- Present owner, if known: William Koeth Address: same
 City: _____ ZIP: _____ Ownership is: Public Private
- Present Use: residence Original Use: _____
 Other past uses: _____

DESCRIPTION

6. Briefly describe the present physical appearance of the site or structure and describe any major alterations from its original condition:

Complex, two-story, stucco house, high pitched, cross gabled roof. Presently there is a bright pink gate, leading into garden which is enclosed by heavily covered brick wall, dense vegetation. House has multilight casement windows. Detached, two-car garage. Heavy vegetation screens view of house from street.

7. Locational sketch map (draw and label site and surrounding streets, roads, and prominent landmarks):

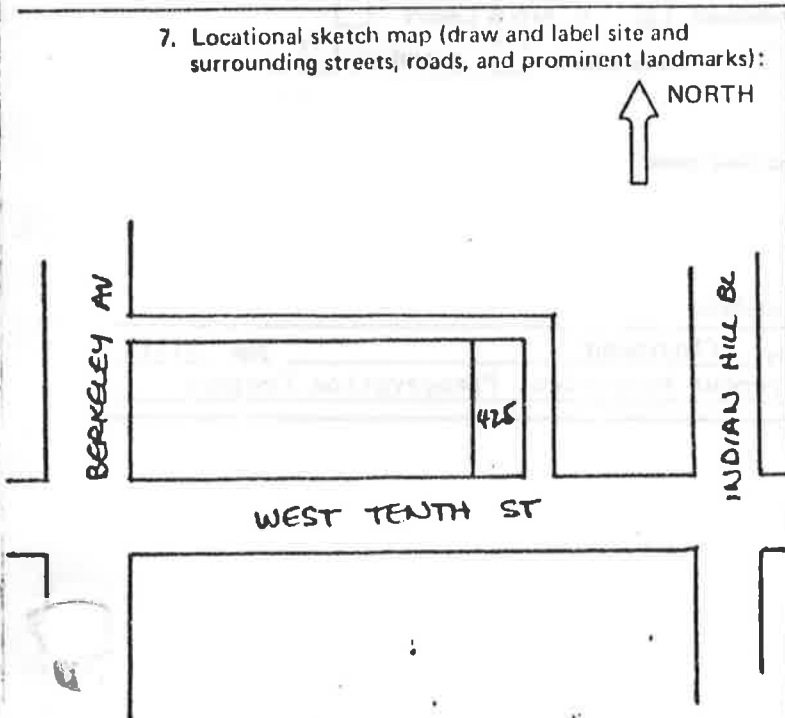

8. Approximate property size:

Lot size (in feet) Frontage 48
 Depth 111.02
 or approx. acreage _____

9. Condition: (check one)

- a. Excellent b. Good c. Fair
 d. Deteriorated e. No longer in existence

10. Is the feature a. Altered? b. Unaltered?

11. Surroundings: (Check more than one if necessary)

- a. Open land b. Scattered buildings
 c. Densely built-up d. Residential
 e. Commercial f. Industrial
 g. Other

12. Threats to site:

- a. None known b. Private development
 c. Zoning d. Public Works project
 e. Vandalism f. Other

13. Date(s) of recorded photograph(s):

NOTE: The following (Items 14-19) are for structures only.

14. Primary exterior building material: a. Stone b. Brick c. Stucco d. Adobe e. Wood
f. Other
15. Is the structure: a. On its original site? b. Moved? c. Unknown?
16. Year of initial construction 1927 This date is: a. Factual b. Estimated
17. Architect (if known): Margaret Woodford (wife)
18. Builder (if known): Clarence Stover
19. Related features: a. Barn b. Carriage house c. Outhouse d. Shed(s) e. Formal garden(s)
f. Windmill g. Watertower/tankhouse h. Other i. None

SIGNIFICANCE

20. Briefly state historical and/or architectural importance (include dates, events, and persons associated with the site when known):

House was built by Joseph (Jimmy) Woodford, member of old Claremont family, whose family had owned large, old house on Southwest corner of 7th and Yale (where present condominiums are).

This house is now identified by its bright pink gate and well maintained, but overgrown privacy hedges and trees. The present residents enjoy their privacy but the neighbors cannot enjoy the house.

21. Main theme of the historic resource: (Check only one): a. Architecture b. Arts & Leisure
c. Economic/Industrial d. Exploration/Settlement e. Government f. Military
g. Religion h. Social/Education

22. Sources: List books, documents, surveys, personal interviews, and their dates:

George Bellemin
A. O. Woodford

23. Date form prepared: Feb. 1979 By (name): Kathy Steadman
Address: 544 W. 10th St. City Claremont ZIP: 91711
Phone: 624-4450 Organization: Claremont Historical Preservation Project

(State Use Only)



B. A. WOODFORD

The life work of B. A. Woodford of Claremont, former general manager of the California Fruit Growers Exchange, is so closely interwoven with the history of cooperative marketing as exemplified by that body, that his name will always stand out clearly and prominently as one of the earliest and most forceful leaders this great movement has had. The work of these public-spirited men has made possible the present prosperous condition of the citrus industry in Southern California, and no praise is too great in recognition of their unselfish labor in bringing to completion this gigantic scheme for the protection of the citrus industry.

Born at Westhaven, Hartford County, Conn., in 1860, Mr. Woodford was educated in the public schools of Hartford, and we next hear of him in the Ozark district of southwestern Missouri. There he engaged for eight years in farming and stock raising. The New Englander, however, could not "be shown" by Missouri that corn at twenty cents a bushel and fat hogs and cattle at three cents per pound pointed the high-road to fortune, and he turned toward the West as a more promising field for his endeavors.

Coming to California in 1888, Mr. Woodford first settled at Upland, then North Ontario, and the next five years, being a period of great citrus planting in the state, we find him engaged in grading lands and planting orange groves for himself and others. He soon saw that the marketing of the products would be the big business of the country, and with others organized the Lemon Growers Exchange at Upland, the first association of lemon growers in California and which has been in continuous operation ever since. At that time the commercial packer would not handle lemon shipments East, claiming that the fruit would not keep and could not be successfully sold in competition with the Sicilian lemon.

In 1896, on the election of President McKinley, Mr. Woodford saw the opportunity for obtaining an adequate duty on oranges and lemons as a help to a struggling industry, and through his activities a mass meeting of citrus growers was called and a committee of seven appointed, one from each of the southern counties. As a result, a flat duty of one cent per pound on citrus fruit was obtained. In that same year the Ontario-Cucamonga Fruit Exchange was formed, with Mr. Woodford as manager, and during his term of office the citrus

output in the district was increased from virtually nothing to some 2500 cars annually.

In September, 1904, the California Fruit Growers Exchange resumed operations, with Mr. Woodford as general manager, and for eight years he held this position, in which the work of a lifetime was crowded, with the usual penalty, impaired health for the worker, and he retired to devote his time to developing several groves in the La Verne district, his ambition being to produce one and one-half cars per acre, and he has very nearly reached this productiveness in his orchards; using the most scientific methods of cultivation and sparing no expense to get results.

In 1908, Mr. Woodford assisted in getting the upholding of the citrus industry in the country again before Congress, and the duty on lemons was increased to one and one-half cents per pound, which helped materially in further development in the state, the output now reaching 10,000 cars annually. This effort was put through by the Citrus Protective League.

The marriage of Mr. Woodford, on May 8, 1889, united him with Miss Emma B. Harwood, and five children have been born to them: Alfred, an instructor at Pomona College; Mary; Marjorie; James; and Katherine. Mr. Woodford has joined no fraternal organizations, but has devoted himself exclusively to the upbuilding of the citrus industry in the Valley, and his life work has been crowned with a success of the faith of the pioneers in the industry now being demonstrated by ever-growing proportions. In political issues he supports the Republican party.



History of Clarence Stover - Builder

425 W 10th Street, Claremont, CA 91711

Though Reeves used a Los Angeles architect, he enlisted the services of local contractors W.P. & C.T. Stover to build the theatre. Willard Stover was a resident of Ontario. He was well known in the community and was a member of many civic organizations, most notably the Rotary Club. Clarence Stover was a resident of Claremont. He was a member of the Kiwanis Club, a director of the El Camino Citrus Association and a director of the Claremont Improvement Company.

Clarence was a graduate of Pomona College and after graduation worked for the George McKenna ranches and groves and later for the Pomona Pump Company, along with his brother, where they gained building experience. In 1929 he formed the Stover Company with his brother. The company became one of the largest and most successful to ever operate in the Pomona Valley.

Among their projects, in addition to single residences and entire housing tracts, was the Progress-Bulletin building in Pomona, Clark, Frary and Mudd Halls at Pomona College, the Pomona College Student Union Building and several buildings on the Los Angeles County Fairgrounds, including the grandstand and the Fine Arts Building. Most notable of their residences was the McKenna House at 500 West 11th Street and the Garner House in Memorial Park. He was the builder of Claremont High School (The Old School House), the Courier Building (Press Restaurant) and most of Harvard Avenue between First and Second Streets.



THE [illegible] OF [illegible]

[The main body of the document contains several paragraphs of text that are extremely faint and illegible due to the quality of the scan. The text appears to be a formal document or report.]